

BASS PRO SHOPS.

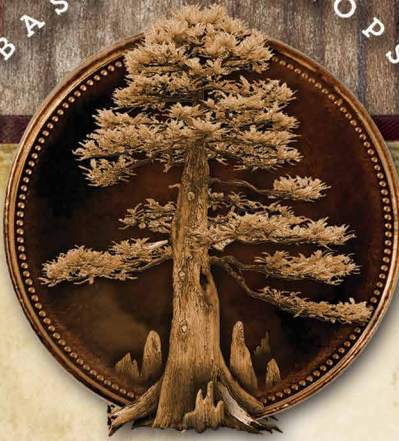

BIG CYPRESS LODGE

EVENT SPACES



~ WWW.BIG-CYPRESS.COM ~



Meetings and Events at Big Cypress Lodge

Located inside the renowned Memphis Pyramid, Big Cypress Lodge is the perfect place to host a group event or meeting. This one-of-a-kind facility offers a variety of private spaces, including a large banquet room which holds 350 guests, breakout spaces seating between 40 and 60 guests and a boardroom that will accommodate 10 guests. For larger groups, events can be hosted on the Mississippi Terrace. The Lookout at the Pyramid can also be reserved for extra special occasions.

INDEX

EVENT SPACE	PAGE
Cattail Boardroom	3
Delta / Gator Room	4
Flyway Room.....	5
Ducks Unlimited / Waterfowl Gallery	6
Mississippi Terrace	7
Uncle Buck's Trophy Room.....	8
The Lookout at the Pyramid.....	9

CATTAIL BOARDROOM

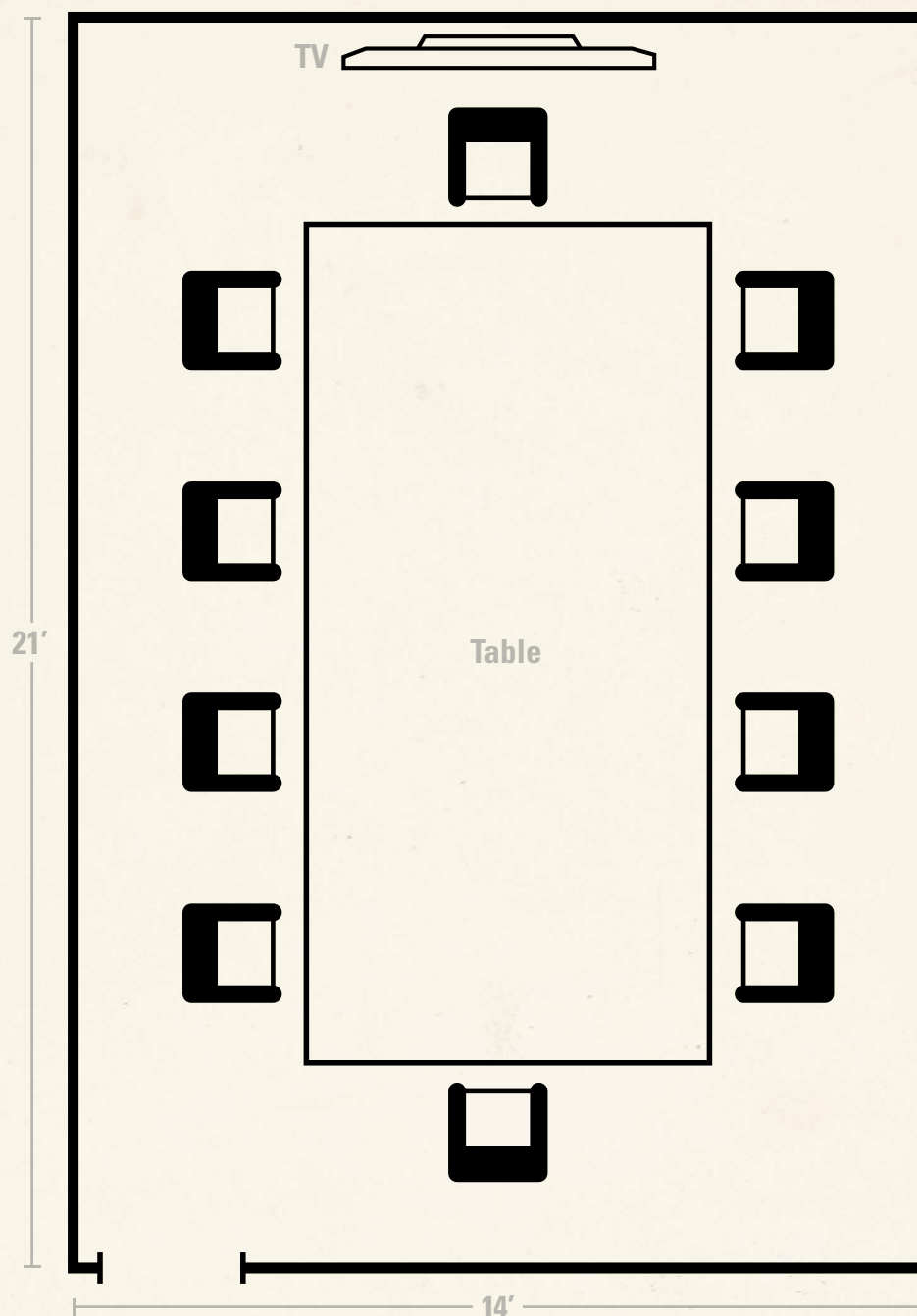

Big Cypress Event Space	Square Footage	Max Capacity	Theater Seating	Round Seating	Classroom Seating	Reception	U-Shape
Cattail Boardroom	294	10	—	—	—	—	—

Room square footages are approximate. Maximum room capacities do not include extra room features such as buffets, screens, projectors, podiums and bars.

DELTA / GATOR

Extra Room Features Available:

Buffets, Podiums, Bars

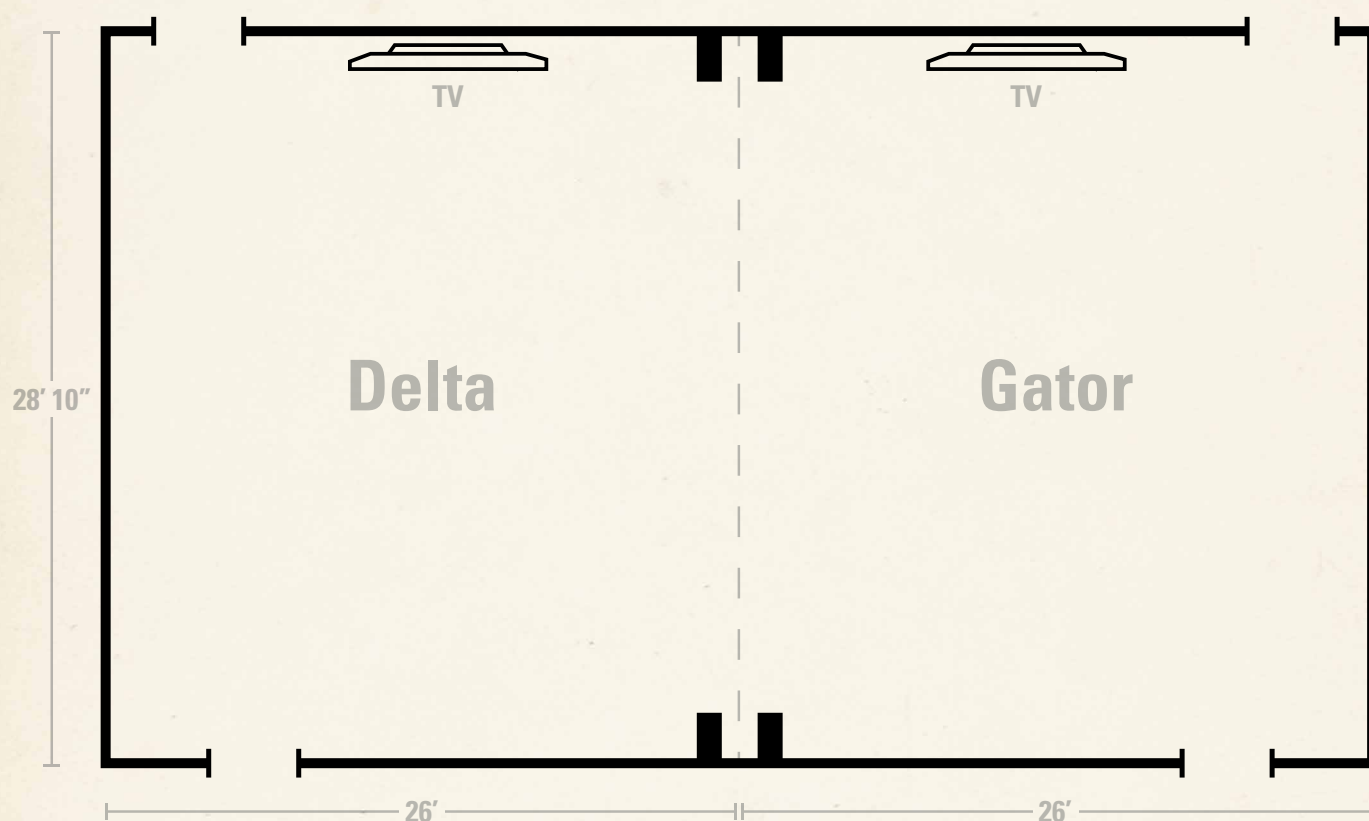

Big Cypress Event Space	Square Footage	Max Capacity	Theater Seating	Round Seating	Classroom Seating	Reception	U-Shape
Delta Room	754	105	95	40	40	105	24
Gator Room	754	105	95	40	40	105	24
Delta + Gator Rooms	1,508	200	190	80	80	200	48

Room square footages are approximate. Maximum room capacities do not include extra room features such as buffets, screens, projectors, podiums and bars.

FLYWAY

Extra Room Features Available:

Buffets, Podiums, Bars

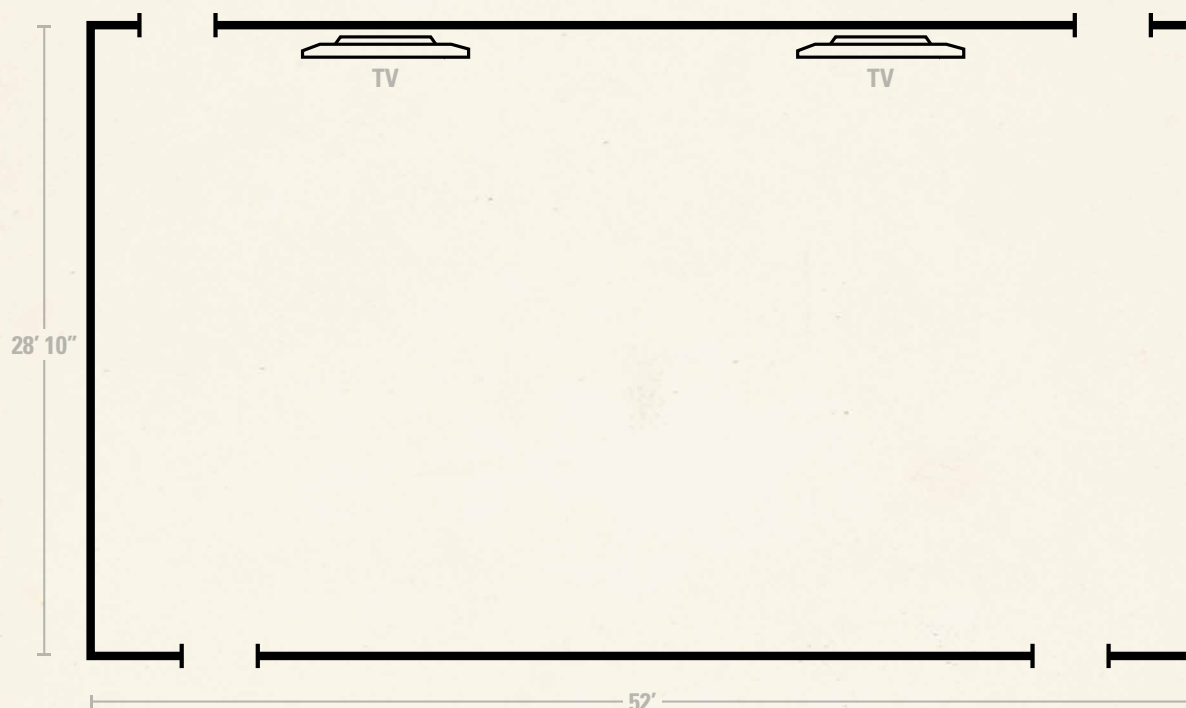

Big Cypress Event Space	Square Footage	Max Capacity	Theater Seating	Round Seating	Classroom Seating	Reception	U-Shape
Flyway Room	1,508	200	88	80	210	48	24

Room square footages are approximate. Maximum room capacities do not include extra room features such as buffets, screens, projectors, podiums and bars.

DUCKS UNLIMITED / WATERFOWL GALLERY

Extra Room Features Available:

Buffets, Screens, Projectors, Podiums, Bars, Dance Floors

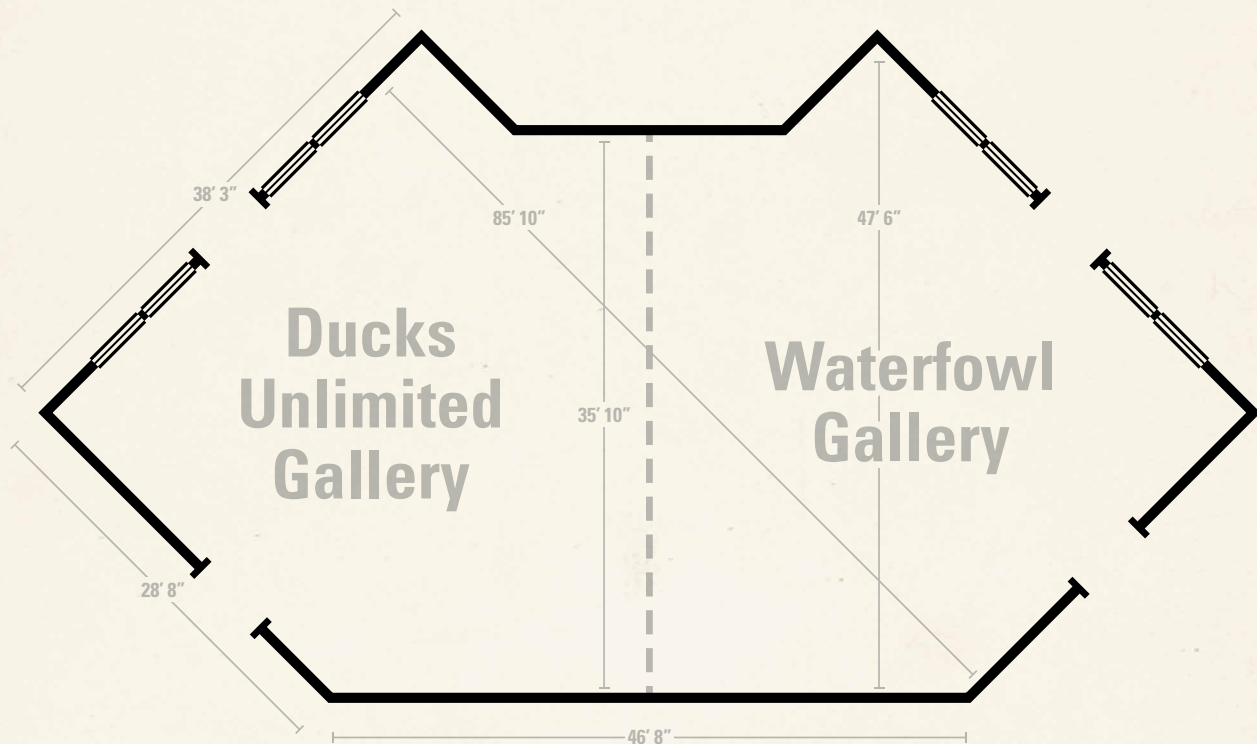

Big Cypress Event Space	Square Footage	Max Capacity	Theater Seating	Round Seating	Classroom Seating	Reception	U-Shape
Ducks Unlimited Gallery	1,400	175	160	80	88	175	32
Waterfowl Gallery	1,400	175	160	80	88	175	32
Waterfowl + Ducks Unlimited	2,800	350	320	168	176	350	48
Waterfowl + Ducks Unlimited + Mississippi Terrace	10,530	800	—	460	—	750	—

Room square footages are approximate. Maximum room capacities do not include extra room features such as buffets, screens, projectors, podiums and bars.

MISSISSIPPI TERRACE

Extra Room Features Available:

Buffets, Screens, Projectors, Podiums, Bars, Dance Floors

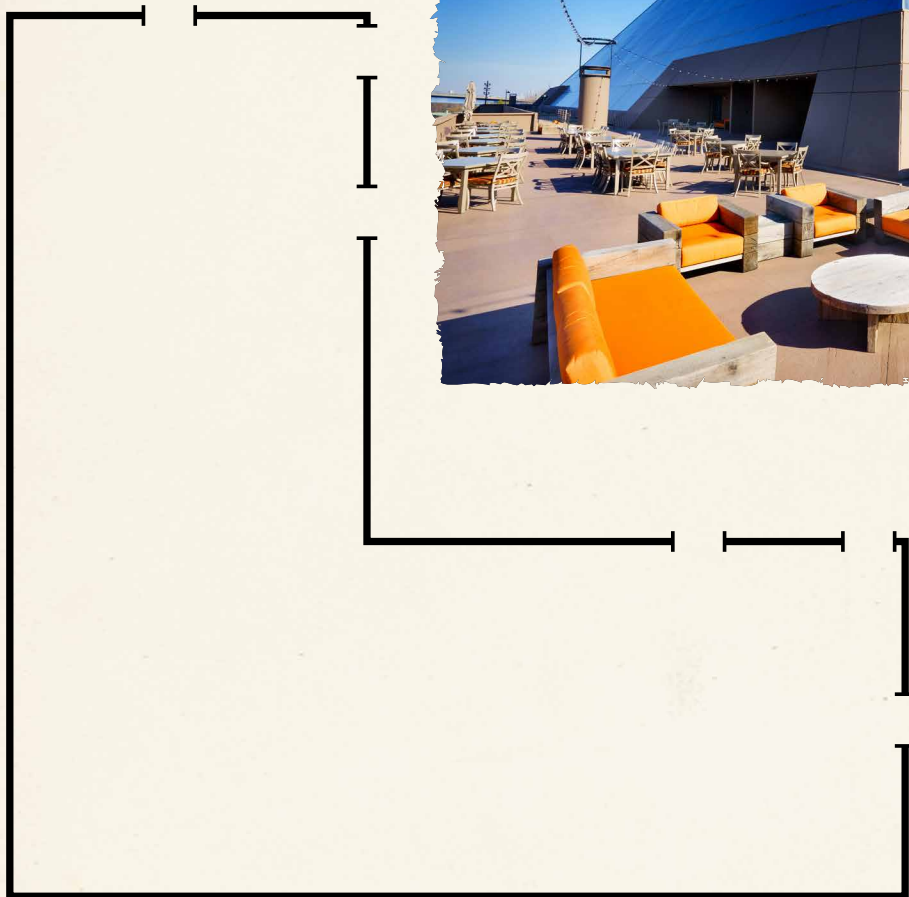

Big Cypress Event Space	Square Footage	Max Capacity	Theater Seating	Round Seating	Classroom Seating	Reception	U-Shape
Mississippi Terrace	7,730	500	—	280	—	500	—
Waterfowl + Ducks Unlimited + Mississippi Terrace	10,530	800	—	460	—	750	—

Room square footages are approximate. Maximum room capacities do not include extra room features such as buffets, screens, projectors, podiums and bars.

UNCLE BUCK'S TROPHY ROOM

Located off of Uncle Buck's Fish Bowl & Grill, this one-of-a-kind billiards experience features a fireplace, luxurious dark wood paneling and a tournament table for the ultimate in gaming fun!

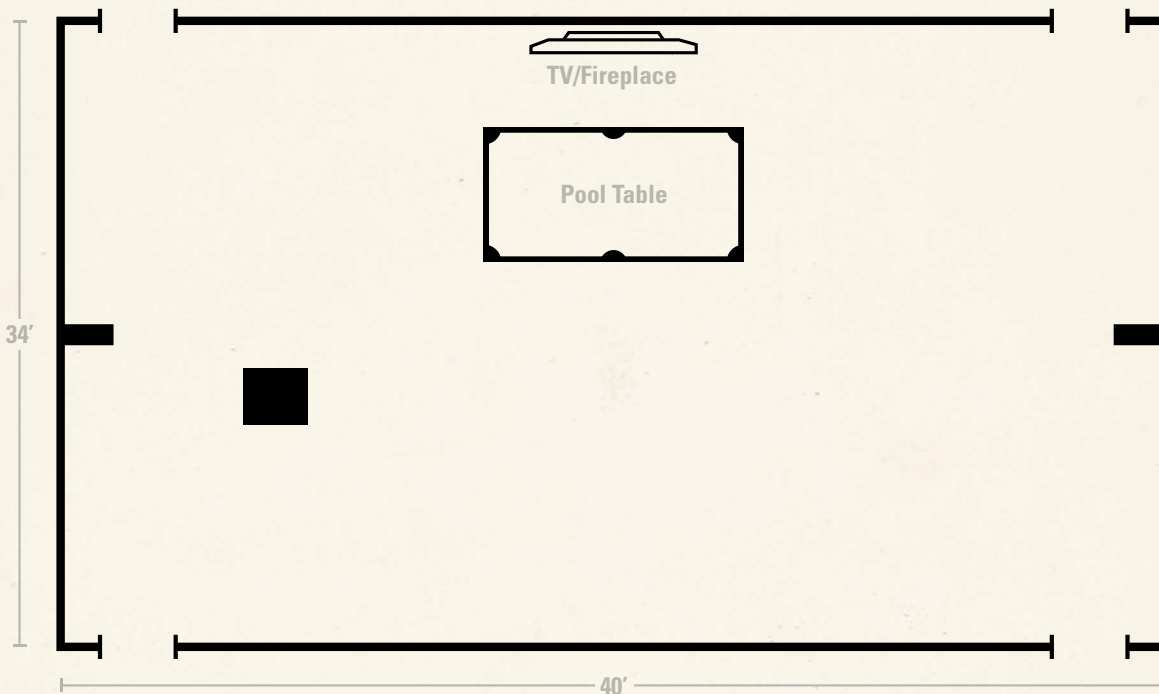

Big Cypress Event Space	Square Footage	Max Capacity	Theater Seating	Round Seating	Classroom Seating	Reception	U-Shape
Uncle Buck's Trophy Room	1,360	80	60	—	40	80	24

Room square footages are approximate. Maximum room capacities do not include extra room features such as buffets, screens, projectors, podiums and bars.

THE LOOKOUT AT THE PYRAMID

Take a ride in the nation's tallest free-standing glass elevator and experience The Lookout at the Pyramid. Enjoy unique food and specialty drinks while taking in spectacular views of Memphis from 300 feet in the air. The steampunk-style décor is complemented by an aquarium in the middle of the restaurant and two glass viewing decks.

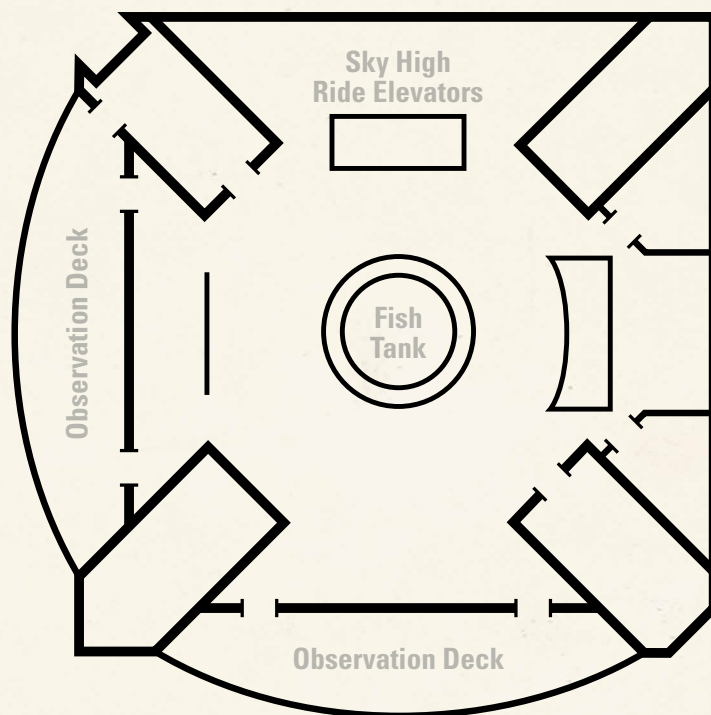

Big Cypress Event Space	Square Footage	Max Capacity	Theater Seating	Round Seating	Classroom Seating	Reception	U-Shape
The Lookout at the Pyramid		200	—	100	—	200	—

Room square footages are approximate. Maximum room capacities do not include extra room features such as buffets, screens, projectors, podiums and bars.



BIG CYPRESS LODGE

It is our goal to make your event at Big Cypress Lodge meaningful and memorable. Contact us today to plan your next meeting or group event.

Big Cypress Lodge
1 Bass Pro Drive
Memphis, TN 38105
901-620-4652
www.big-cypress.com